



# REPT HABITAT PRO 120

2' x 2' x 4'  
(61cm x 61cm 122cm)  
PVC cage  
(Approximately  
120 gallons or 454 liters)



GALLONS

## INSTRUCTIONS

Thank you for purchasing Zoo Med's new Repti Habitat Pro 120. The following instructions will assist you with the assembly of your new habitat. Please note that the instructions below include general set-up information and proper use. It is very important that you learn about the specific needs of your species to create the most appropriate habitat for your pet. If you have any questions regarding these instructions or the proper use of this item, please contact our customer service department by emailing [zoomed@zoomed.com](mailto:zoomed@zoomed.com) or by calling 805.542.9988.

Scan for  
instructional  
video



### LIST OF PARTS

- A. 1x Floor panel
- B. 2x Side panels
- C. 1x Back panel
- D. 1x Lower glass panel (substrate)
- E. 1x Lower door rail
- F. 2x Glass doors
- G. 4x Vertical corner posts
- H. 1x Top panel
- I. 1x Lock
- J. 4x Risers

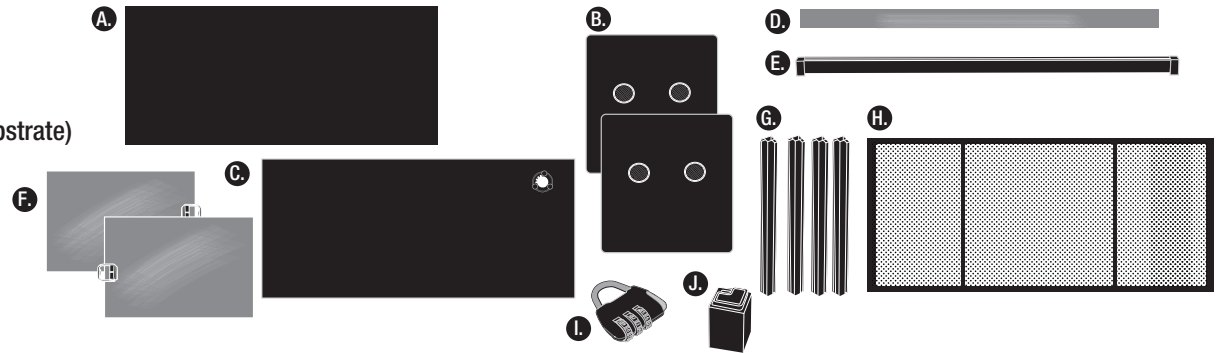

### ASSEMBLY INSTRUCTIONS:

\*NOTE: The letter "A" should be at the front of the habitat in all instances

1. Place the **Floor panel (A)** on a flat surface

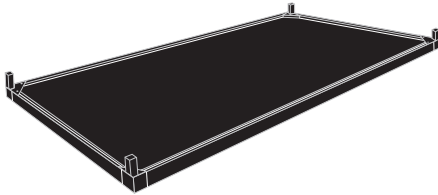

2. Insert the **Vertical corner posts (G)** on each corner being sure that the 2 posts labeled with the letter "A" are placed on the 2 front corners

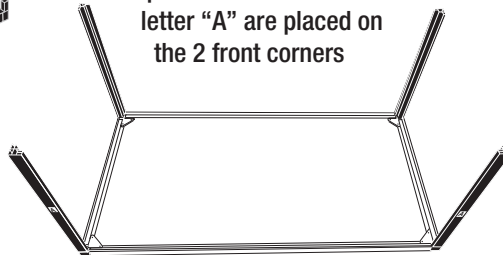

3. Slide the **Back panel (C)** into the back corner posts



4. Slide the **Side panels (B)** into place with the vents positioned as shown

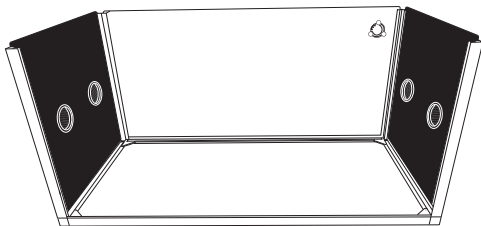

5. Slide the **Lower glass panel (D)** between the front vertical corner posts, then slide in the **Lower door rail (E)** and rest it on top as shown

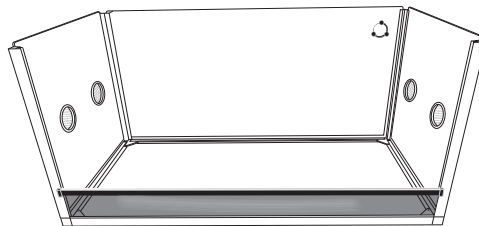

6. Place the **Top panel (H)** as shown, inserting the plastic corner brackets into the vertical corner posts. Be sure that the letter "A" is facing the front of the habitat

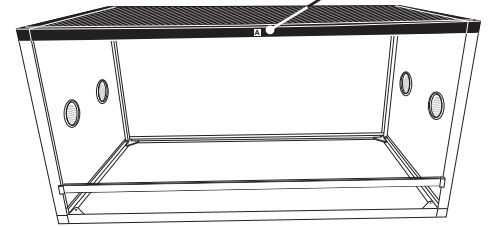

7. To install the first **Glass door (F)**, inspect the Lower door rail and observe two "tracks". Slide the top edge of the Glass door into the top, rear door track. Lift the door up, then seat it into the bottom, rear track. Slide this door to the side and latch it, then install the second **Glass door (F)** into the front track, ensuring that the latch is positioned at the opposite side of the habitat from the first. Slide the top edge of the door into the top, front door track, then lift the door up and seat it into the bottom, front track.

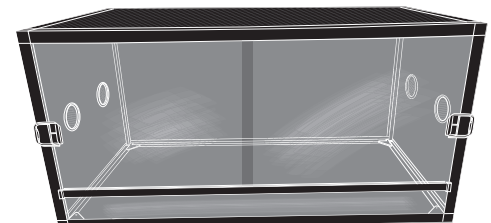
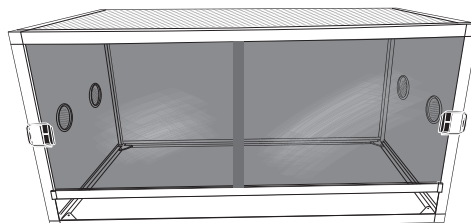
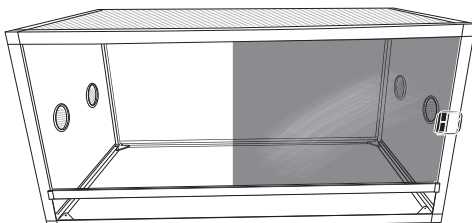

8. The Repti Habitat Pro 120 comes with unique, locking latches that keep your habitat secure! To use these latches, follow these steps:

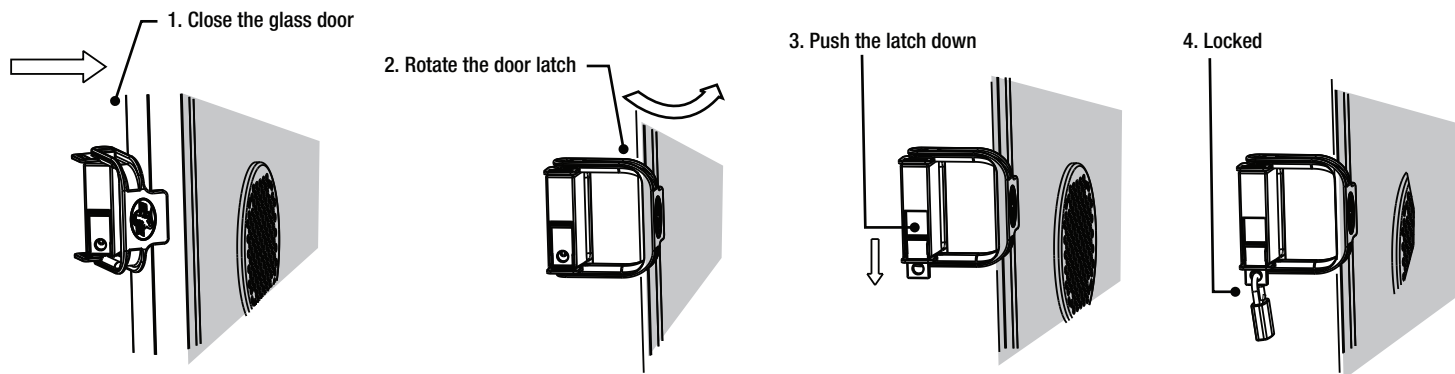

**LOCK INSTRUCTIONS:**



**A. Open the lock**

Turn each dial so that the combination reads 0-0-0 along the bottom center line.



**B. Change the code**

Keep the lock head open and use a pen tip or paperclip to press into the small hole on the side of the lock. \*NOTE: It is important to keep the pen or paperclip firmly depressed throughout the process.



**C. Turn the lock dial.**

Keep the pen firmly depressed into the hole, turn each dial to the new desired code. Remember to align the new code with the bottom center line. Record the new code in a secure location.



**D. Save the changes.**

Remove the pen or paperclip from the hole, and the new code is set. Scramble the numbers, then test your new code.

9. If you are stacking the habitats, install the included **Risers (J)** on top of the corners, then carefully place the second habitat on top ensuring that the risers are fully seated in each corner.

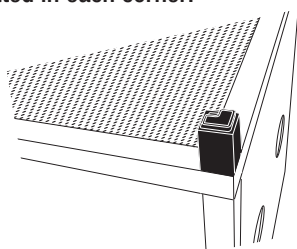

10. To install electrical appliances like waterfalls inside the habitat, you can use the cord port to pass electrical cords through. Simply remove the port cover by twisting to the unlocked position, then pull it straight off. Pass the cord through and feed it into one of the small openings, then place the cover back on, twisting to lock it into place.



**CARE TIPS:**

The Repti Habitat Pro 120 habitat is easy to clean and sanitize! Use WipeOut 1 to wipe down and sanitize all surfaces in the habitat. Wipe Out Glass Cleaner can be used to clean and polish the glass front.

**PRECAUTIONS:**

- Do not leave this habitat outdoors. PVC can be damaged by direct, unfiltered sunlight.
- Under Tank Heaters should not be used on this type of habitat, as PVC's insulation hinders heat transfer.
- PVC plastic is susceptible to damage from direct, high-heat. Be sure that all heating elements are approved for use with PVC and are used according to manufacturer directions. Heat lamps, projectors, and emitters should not be placed too close to the PVC panels.
- While PVC holds up to moisture and high humidity, the base of this habitat is not water tight so care should be taken when adding water to substrate.

**WARRANTY:**

Zoo Med Laboratories, Inc. (Zoo Med) warrants each **Repti Habitat Pro 120** to be free of defects in material and workmanship under normal use and service for one year from the date of purchase. The obligation under this warranty is limited to the repair or replacement, at Zoo Med's discretion, of the product or any part thereof, when the product is returned to Zoo Med, freight prepaid. No claim shall be allowed under this warranty if, in the opinion of Zoo Med, the **Repti Habitat Pro 120** has been subject to accident or improper usage, including but not limited to: water damage, improper storage, accidental dropping, etc. This warranty is in lieu of all other warranties and representations expressed or implied. Please include your receipt, full name, address, phone number, and email address along with a note explaining failure when sending any product back to Zoo Med. Please allow 4 to 6 weeks for repair or replacement.