



# AQUAEFFECTS

MODEL 2

INSTRUCTIONS

AQUARIUM LED LIGHT EXPERIENCE with built in lighting and sound effects

ITEM#'s: AE2-20, AE2-24,  
AE2-36 & AE2-48

Congratulations on your purchase of Zoo Med's **AQUAEFFECTS MODEL 2** Aquarium LED Light Fixture! The following instructions will assist you with the proper set-up and operation of this light fixture. Please read the following instructions carefully. If you have any questions regarding these instructions or the proper use of this item, please contact our customer service department at [zoomed@zoomed.com](mailto:zoomed@zoomed.com) or by calling (888) 496-6633 (US and Canada only). Customers in other countries, please call (805) 542-9988.

## FEATURES:

- Synchronized natural sound effects
- Controlled with wireless remote
- Built-in 24 hour timer with sunrise and sunset transitions
- Customizable day/night spectrums and four customizable memory bank buttons
- True UVA to enhance fish vision and encourage more natural behaviors
- Five adjustable color channels
- 30 minute long sunrise and sunset transitions with unique colors
- High-output LEDs are great for planted aquariums
- Bright lights produce natural shimmer effect
- Adjustable mounting legs allow fixture to rest on your tank's edges
- Aluminum housing for improved heat transfer and longer life

## IMPORTANT SAFETY NOTICE!

To reduce the risk of fire, injury, or electric shock, read and follow these instructions prior to operating this light fixture. Save these instructions for future reference.

## SAFETY INSTRUCTIONS:

- Caution must be taken when using electrical appliances near water. To reduce the risk of **electric shock**, be sure that the lamp fixture is unplugged during any of the following situations:
  - Unplug when installing the light fixture on or over your aquarium.
  - Unplug when performing aquarium maintenance.
  - Unplug before placing your hand(s) in the water of the aquarium. Be sure that your hands are completely dry before plugging the light fixture into an appropriate electrical outlet.
  - Unplug if the light fixture comes into direct contact with water, or if any part of the light fixture becomes wet (other than drops of water on the outside of the clear splash guard).
  - Unplug when not in use.
- When unplugging the lamp fixture, grasp the plug to prevent damage to the power cord. Never pull on the power cord to unplug the lamp fixture.
- **DO NOT** exceed electrical rating. Lamps must be of the correct wattage as noted on the product packaging. If you are unsure about which lamp to use, contact our customer service department for assistance at the phone number listed above.
- **DO NOT** splice, repair, or modify the power cord. Inspect the power cord periodically for damage.
- For indoor use only.
- Keep children and pets (other than your aquarium inhabitants) away from fixture.
- **DO NOT** alter or modify this product. Contact an electrician if you are unsure about the electrical connection.

**DRIP LOOP:** This lamp fixture must be used near a grounded receptacle with a “drip loop” (see figure 1). The drip loop will prevent water from running along the power cord and getting the plug or wall receptacle wet. To create a drip loop, be sure that a portion of the power cord is lower than the level of the wall receptacle as shown in figure 1. If for any reason the plug or wall receptacle gets wet, do not grasp or unplug the power cord until after the power has been switched off at the main fuse or circuit breaker.

**GROUND FAULT PROTECTION:** To reduce the risk of electric shock, this light fixture must be plugged into a **GFCI receptacle** (see figure 2). If you are unsure about the electrical supply and connection, contact a qualified licensed electrician.

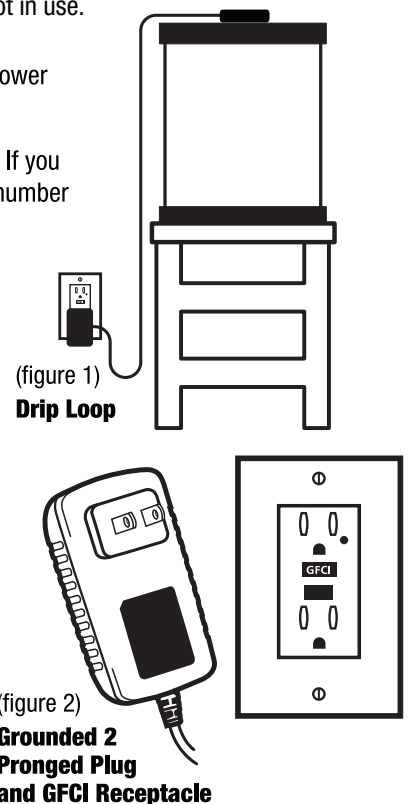

(figure 1)

**Drip Loop**

(figure 2)

**Grounded 2  
Pronged Plug  
and GFCI Receptacle**

## INSTALLATION USING SLIDING RAILS:

Check to make sure that the light fixture is unplugged before installing the fixture on the aquarium. To install using the adjustable sliding rails, adjust the width of the rails to match the width of the aquarium, and securely place the fixture on the frame of the aquarium. Each rail should be extended the same amount, and should not be pulled completely from the aluminum housing.

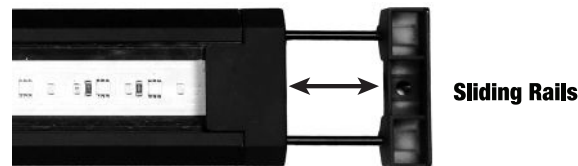

## OPERATING INSTRUCTIONS

- Adjust mounting legs to fit the length of your aquarium and place the fixture on your tank.
- Plug transformer into appropriate GFCI protected outlet, ensuring the controller unit and speaker are accessible.
- Press the **POWER** button (A) to power on your fixture.
- To view a particular mode or effect, press one of the eight buttons below:

### STATIC MODES (C)

- **SUN:** All lights on. (*Sound – Flowing river*)
- **MOON:** Blue light only. (*Sound – Nighttime lake*)
- **FISH:** White, blue, and UV only. (*Sound – Lake waves*)
- **PLANT:** All light on with additional red brightness. (*Sound – Jungle stream*)

### DYNAMIC EFFECTS (I)

- **WAVES:** Gentle waves crashing onto the shore.
- **MOON and CLOUDS:** Clouds passing in front of a full moon.
- **CLOUDS:** Overcast skies with cloud motion.
- **STORM:** Thunderstorm and lightning.

- To adjust the volume of the sound effects, press the volume up or volume down arrows. Press the center mute button to mute all sound (G). When muted, dynamic effects will change to a static weather spectrum with no additional light effects.
- To adjust the brightness of all colors simultaneously, press the brightness up or brightness down arrows (static modes only) (H).

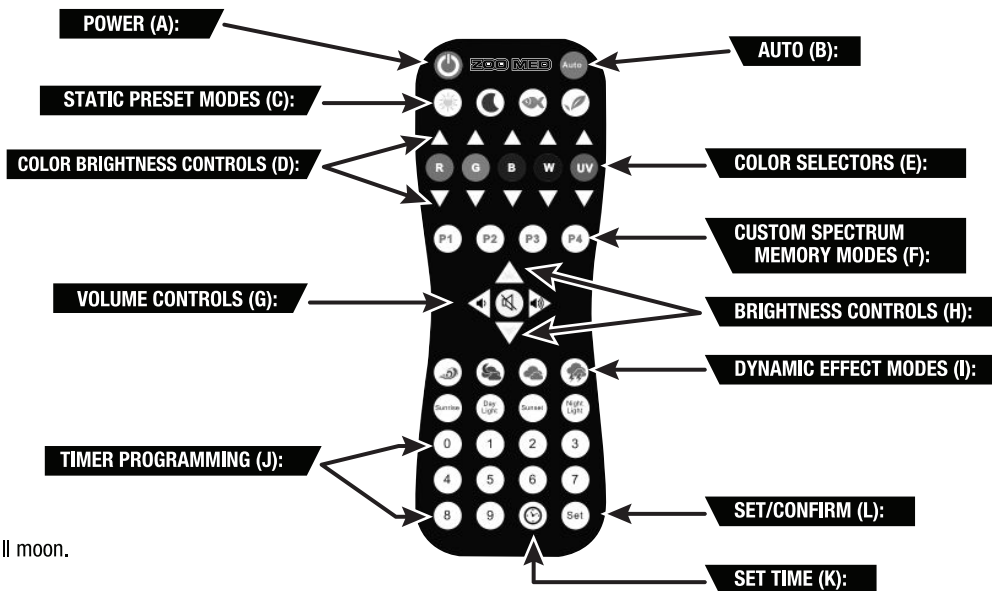

## PROGRAMMING THE TIMER

1. To set the current time, press and hold the “**clock**” button (K) until the unit flashes once. Enter the current time on the number pad (J) using 24-hour “**military**” time format. (*Example: 8:30 AM should be input as 0830, and 8:30 PM should be input as 2030.*)
  - a. Lights will flash once when the time has been successfully set
  - b. Lights will flash three times if an invalid time has been selected or when there has been no operation for 10 seconds.
2. Press and hold “**Sunrise**” button. Enter the desired daylight start time on the number pad using 24-hour “**military**” time. To set the time for the beginning of the night cycle, repeat this step by pressing and holding “**Sunset**” and entering the desired night cycle start time on the number pad.
3. To adjust the daytime spectrum, press and hold the “**Daylight**” button. When the light flashes once, change the color spectrum as desired using the individual color control arrows (D). When satisfied, press “**SET**” (L). The unit will flash once when the setting is saved successfully. The fixture will switch to this spectrum automatically during daylight hours.
  - a. To change the nighttime spectrum, repeat the step above, pressing and holding the “**Nightlight**” button prior to adjusting the nighttime spectrum to your liking. Press “**SET**” (L) to save your new night setting.
4. Press the “**Auto**” button (B) to enter back into the timer mode anytime during operation. The spectrum will automatically adjust to the appropriate day or night spectrum based on the current time that you have set.

## STORING CUSTOM SPECTRUM SETTINGS

1. Press one of the memory mode buttons: **P1, P2, P3, or P4** (F).
2. Pressing one of the five center color buttons (E) will instantly switch the light to that specific color at maximum brightness. To adjust the brightness of multiple colors individually, use the color brightness up/down arrows (D) to change each color to your liking.
3. Once satisfied with the customized color spectrum, store the new spectrum by pressing and holding one of the memory mode buttons (F). When the light flashes once, the spectrum has been saved and will adjust to the custom spectrum automatically when the memory button is pressed in the future.

## WARRANTY:

Zoo Med Laboratories, Inc. (Zoo Med) warrants each **AQUAEFFECTS MODEL 2** Aquarium LED Fixture to be free of defects in material and workmanship under normal use and service for one year from the date of purchase. The obligation under this warranty is limited to the repair or replacement, at Zoo Med’s discretion, of the product or any part thereof, when the product is returned to Zoo Med, freight prepaid. No claim shall be allowed under this warranty if, in the opinion of Zoo Med, the **AQUAEFFECTS MODEL 2** Fixture has been subject to accident or improper usage, including but not limited to: water damage, improper storage, accidental dropping, etc. This warranty is in lieu of all other warranties and representations expressed or implied. Please include your receipt, full name, address, phone number, and email address along with a note explaining failure when sending any product back to Zoo Med. Please allow 4 to 6 weeks for repair or replacement.

**ZOO MED LABORATORIES, INC.** 3650 Sacramento Dr. • San Luis Obispo, CA 93401 U.S.A. • Phone: 805-542-9988 • E-mail: zoomed@zoomed.com

**zoomed.com**